

**Report: 123456789**

**Claim: 987654321**

**Your Company Name**

7/06/2010

**123 Main St., My Town, USA**



**This document is a new feature for our Standard Reports.** As an added benefit, this document contains a photo of the property, notes diagram and pitch-area table to help you estimate the roof area on-site. We provide this attachment in addition to the usual link to our website where you can select pitch values and generate your Standard Report. You will not see any changes in your Standard report. EagleView is offering this as part of our ongoing commitment to upgrading and improving the aerial measurement reporting process for you.

This document is provided under License by EagleView Technologies, Inc. to the requestor for their Internal Use Only subject to the terms and conditions previously agreed to by the Requestor when they registered for use of EagleView Technologies, Inc. Services.

It remains the property of EagleView Technologies, Inc. and may be reproduced and distributed only within the Requestor's Company. Any reproduction or distribution to anyone outside of the Requestor's company is strictly prohibited. All aspects and handling of this report are subject to the Terms and Conditions previously agreed to by the Requestor.

**Notes Diagram**

Roof facets are labeled from smallest to largest (A to Z) for easy reference.

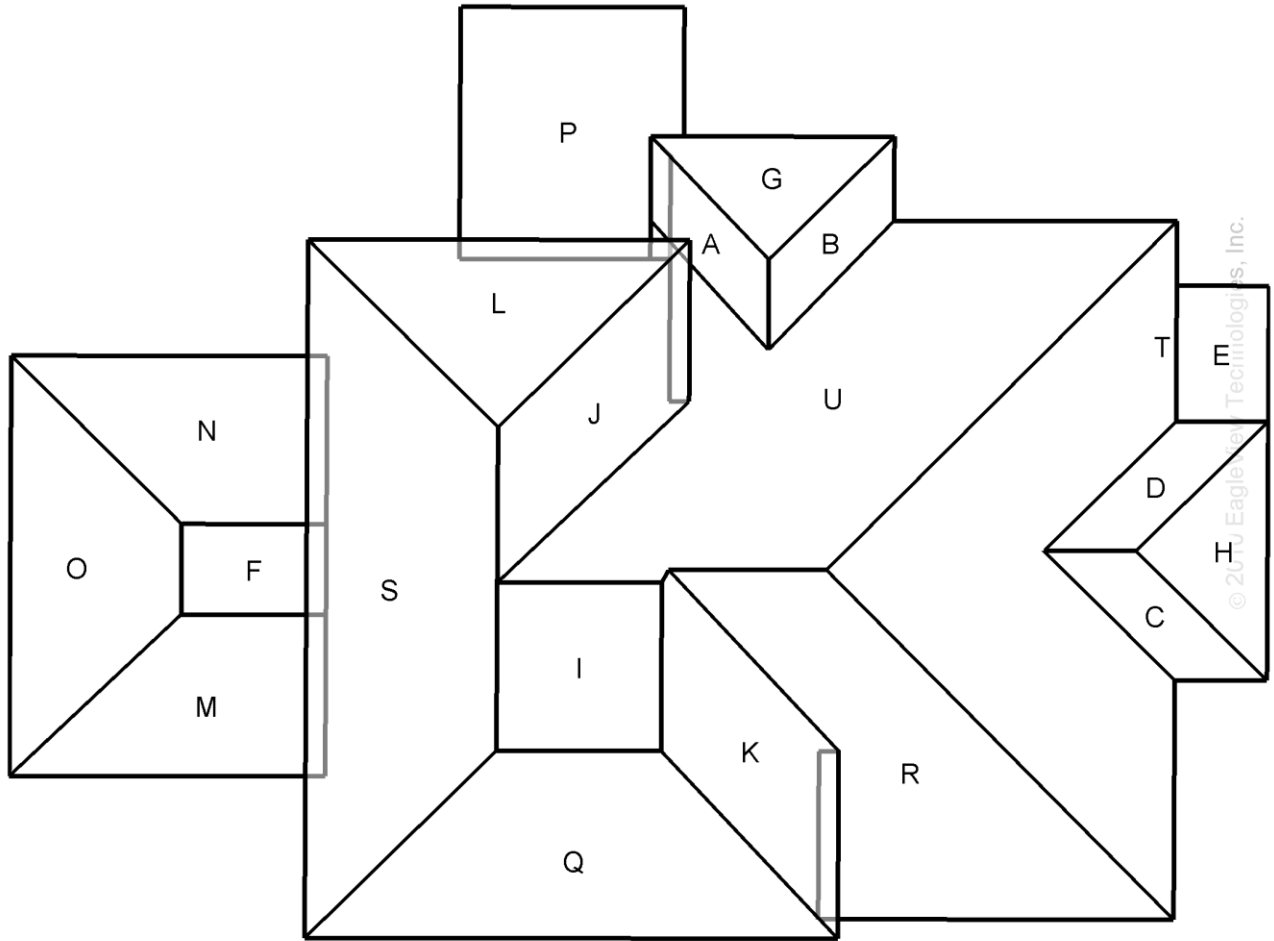

© 2009 EagleView Technologies, Inc.

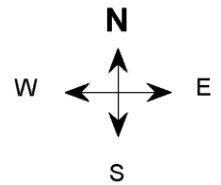

**Facet Area (sq ft) Based Upon Pitch**

The area for each facet appears in the column under the appropriate pitch.

Facet	Pitch (inches per foot)										
	0	2	4	6	8	10	12	14	16	18	20
A	61	62	64	68	73	79	86	93	101	110	118
B	64	65	68	72	77	83	91	99	107	116	125
C	70	71	74	78	84	91	99	108	117	126	136
D	70	71	74	78	84	91	99	108	117	126	136
E	73	75	77	82	88	96	104	113	122	133	143
F	77	78	81	86	93	100	109	118	128	139	150
G	88	89	93	98	106	114	124	135	146	158	171
H	100	101	105	112	120	130	141	154	167	180	194
I	162	165	171	182	195	212	230	250	271	293	316
J	178	180	187	199	213	231	251	273	296	320	345
K	196	198	206	219	235	255	277	301	326	353	380
L	210	213	222	235	253	274	297	323	350	379	409
M	219	222	231	245	263	285	309	336	365	394	425
N	227	231	240	254	273	296	322	350	379	410	442
O	257	260	271	287	309	334	363	395	428	463	499
P	321	325	338	359	386	418	454	493	535	578	624
Q	384	390	405	430	462	500	543	590	640	693	747
R	441	447	465	493	530	574	624	678	735	795	858
S	573	581	604	640	688	746	810	880	955	1,033	1,113
T	615	624	649	688	740	801	870	946	1,026	1,110	1,196
U	674	683	710	754	810	877	953	1,036	1,123	1,215	1,310
<b>Total</b>	5,061	5,131	5,335	5,658	6,082	6,588	7,157	7,776	8,435	9,124	9,836

Note: Each value is rounded to the nearest square foot. The totals are based on the unrounded values.

Access and edit your Standard Report by logging into your account here:

<https://www.eagleview.com/reports/UI/Login.aspx>